

Courses & Distances of the River from the Elm

- N 27 W 16 ps.
- N 34 W 12 -
- N 36 W 62 -
- N 50 W 43 -
- N 63 W 36 -
- N 84 W 12 -
- S 78 W 18 - to a Spruce
- 199 -

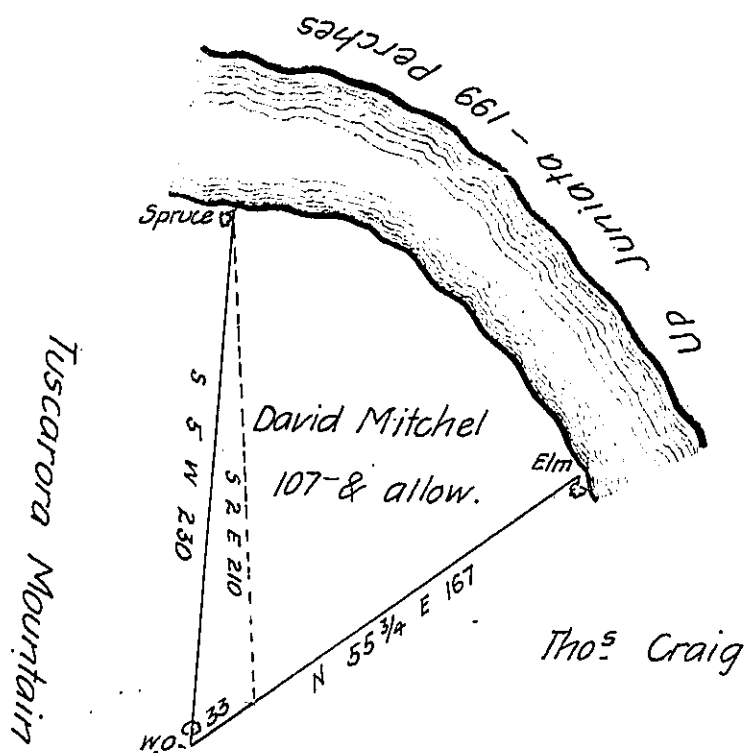

The Draught of a tract of land situated in Juniata Township Cumberland County containing One hundred & seven acres & allow¹¹ of six P. cent for roads &c^e which appears to have been survey^d May 2nd 1794 on a warrant dated 17th of January 1794 The original of which has been delivered over to me by my Predecessor Sam^l Lyon Esqr as an office paper the survey must have been executed under the direction Sam^l Lyon Esqr who was the Deputy Surveyor of the District at the date of the Survey

William Ramsey D.S.

Certify^d July 15th 1801

N.B. It appears as if this Draught was return^d before But the Line N. 55 3/4 E. 167 was wrong W. R.

IN TESTIMONY that the above is a copy of the original remaining on file in the Department of Internal Affairs of Pennsylvania, made conformably to an Act of Assembly approved the 16th day of February, 1833, I have hereunto set my Hand and caused the Seal of said Department to be affixed at Harrisburg, this fifteenth day of November 1905

Joseph P. Pearson
Secretary of Internal Affairs.